



Gem & Mineral Journal



The Official Publication of The Gem and Mineral Society of Lynchburg, VA Inc.

January 2007

Volume 16 Issue 1

Presidents Message:

Hello To All,

What a great year for the GMSL!!! I feel the Club has really grown in 2006. More members are involved in meetings, workshops & special events. There were several presentations at the regular monthly meetings by our own club members that were very educational as well as entertaining. Thanks Dave Woolley & Steve Boylan for a great job, & we hope to see more in the coming year. Members turned out in good numbers at the festivals last year. Now we need to make plans for more in 2007. All this hard work has paid off in our club treasury. I hope to get some ideas from you for purchasing new equipment for the club workshops. Maybe a new cabbing machine or a large diameter rock saw... just a thought. You members know what you would like to have, let your opinions be heard.

Rock hounding in the winter can be a little tough. We have a field trip planned to James-Madison University Geology Dept in late January. This trip has always been educational. If you have a mineral etc. you can't identify bring it along & have Dr. Lance Kerns run a sample through the lab & identify it for you.

There are a few new collecting sights in our area

that I hope we may visit this year. These are quarries that have some very interesting mineral specimens. Also the GMSL is hosting the Dixie Mineral Council Field Trip this year in May. There are a lot of things to do & plans to be made. I hope I can count on everyone to help with this special event. There are people that travel long distances to these DMC trips & we want to make a memorable weekend for them.

All of the Club Officers that served you well last year were voted in again at the December meeting to serve again in 2007. Give them a big thank you next time you meet. Speaking of the December meeting, I would like to thank Bill Gilbert for taking the time to come to Lynchburg. Bill presented multiple awards to Natalie Darling as well as other contributors to our clubs newsletter. We are very proud of our newsletter & all the recognition it has received. Thanks to Natalie for all her hard work & I hope to see more articles contributed by more of our talented club members.

I hope to see you all at the January 17th meeting.

Keep Looking Down,
John Haskins

From the First VP:

Gem amazonite is the mineral for January. Amazonite is potassium aluminum silicate, $KAlSi_3O_8$, and is also called microcline. Amazonite is bright green and has a triclinic crystal structure. Interestingly, in my Audubon Society Field Guide to Rocks and Minerals, amazonite is the next mineral after opal, which is last month's mineral. Both are in the same category of silicate minerals, which is tectosilicates. Amazonite can be found at Morefield Mine, Amelia Virginia. Amazonite is a gregarious rock

that brings a sense of peace and desire to push through and succeed at every endeavor.

We thank Bill Gilbert, regional representative, EFMLS for attending our December Christmas meeting and presenting the newsletter awards. We appreciate his travels back and forth from his home near Richmond. Congratulations to all the contest winners.

As a member of The Gem & Mineral Society of Lynchburg, VA Inc. you are also a member of four other organizations. These
Continued on page 11

2007 ELECTED OFFICERS**John Haskins - PRESIDENT**

(434) 525-8430

JMHaskins1@netzero.net**Steve Boylan****First Vice President**

(434) 534-6108

boylansj@yahoo.com**David Callahan****Second Vice President**

(540) 297-1853

DBCALL1@aol.com**Dee Tinsley- Secretary**

(434) 221-0864

FlyDeeTin@aol.com**Natalie Darling - Editor**

(434) 941-1899

gmsleditor@adelphia.com**Frank Midkiff- Treasurer**

(434) 239-8329

midkiff@aol.com**Members At Large-**

JoAnn Mason &

Ralph Torning

**COMMITTEE
CHAIR PERSONS:****Field Trips-** David Callahan**Hospitality-** Nell McIntyre**News Articles-** Natalie Darling**Silent Auction-** Warren Darling**Special Events-** Dee Tinsley**Swap for Rocks-** Frank Midkiff &
Warren Darling**Website-** Adelaide Lee**Workshops-** Dave Woolley**FRA Adult Liaison**

December Meeting Minutes

Meeting: 7:00 PM, Wednesday,**Attendance:** 38**Hospitality:** Covered dish dinner provided by the members.**Old business:** John Haskins presiding welcomed everyone and thanked the club members for their help and efforts at the Roanoke Show.

John also reminded everyone about the Mt. Athos display and to get his or her specimens to Dave Callahan. Remember also to give your specimens to Dave Woolley for the Native VA minerals for display at Radford College.

First Vice President: Steve Boylan reported that in January we would have a program on OPALS! Like you have never seen before! Come join the "October birthstone presentation".**Second Vice President:** Dave Callahan reported on past field trip to WVA and it's success. He announced we would be going Jan 27, 2007 to JMU to visit their geology department. All who wish to participate can sign up via email or at the next meeting. He reported Lloyd Watson has had his surgery on one eye and will undergo surgery on the second eye on Jan. 4th. Please keep Lloyd in your thoughts and prayers. If all goes well he will be able to see well enough to drive to the

meetings again. Lloyd we all wish you a "Speedy and successful" recovery. We miss you! Dave reported on a series airing on "The Travel Channel" called "The best places to find cash and Treasures". It is a 6 program series and some programs have already aired.

Treasurer: Franklin Midkiff reported that the Treasury has a current balance of \$5163.22 but he has some bills to pay and that will bring the balance to under \$5000.00 again.**New Business:** Welcome was extended to Bill Gilbert, Region 4 Vice President. Bill Gilbert assisted by Natalie Darling handed out the awards. We won a lot considering there are 132 clubs from MAINE TO FLORIDA in our Federation. Awards were presented to Natalie Darling, Steve Boylan, Adelaide Lee, Draper Lee, Dave Woolley and Dee Tinsley. Some of the awards were from the American Federation and some were from the South Eastern Federation. " **This is quite an honor considering you are competing with 132 other clubs.** Write those articles and send them to Natalie, you could be next.

A special note: Natalie Darling deserves a great deal of credit

Continued on page 11

The purpose of the Gem & Mineral Society of Lynchburg, VA, INC. is to promote education in The Earth Sciences including: Mineralogy, Geology, Gemology, Paleontology, and Crystallography

The Gem and Mineral Society of Lynchburg VA, Inc.
Meets on the third Wednesday of each month,
From 7:00pm- 9:00pm
In the auditorium of the Parks and Recreation Building
301 Grove St. Lynchburg, VA 24501
Public is invited, Please join us!

Announcement for January MeetingWednesday, January 17th, 7:00 PM

Virgin Valley Opals by Ed Blackwell join us for our first program of the year and learn about these beautiful gems from Nevada.

**Announcement for February Meeting**Wednesday, February 21st, 7:00 PM

Morefield Mine and Alaska - Sam and Sharon Dunaway

A message from your Secretary:

"Thank you for putting your faith and trust in me as your Secretary for the past year. I look forward to serving you as Secretary for 2007. I also want to "thank" each of you for your wonderful friendships. I am "so happy Jean recruited me".

Merry Christmas and Happy New Year to all of you!

Dee

Sunshine News

Well wishes to club members Bill Gilbert and Lloyd Watson as they recover from recent surgeries. Also to John Haskins who continues to struggle with kidney stones.

I hope everyone had a happy and healthy holiday season, and hope to see you on a field trip or at a meeting or workshop soon!

Welcome New Members:

Dewitt Shank
of Lewisburg,
WV

David Lipscomb
and Debbie
Grainger of
Faber, VA

**Executive Board Meetings**

Are held on the first Wednesday of each month, at 7:00PM unless otherwise noted. Members who would like to learn more about the committee, or wishing to share ideas, are invited to attend any committee meeting. Please contact any officer for details and directions.

Field Trip Report



There were very few places to find collectable minerals but earlier Royce had spotted an area of white feldspar, calcite and quartz that carried some very nice specimen material. We found chalcopryrite, bornite and pretty green feldspar. We suspect that the weathering of the copper bearing calcopryrite and bornite caused the green color throughout the white feldspar. It was in an area covering about two square feet and we carefully collected it all. Royce said that several months ago, this area was much larger and it had been lost in the quarry activity.

I hope everyone was able to collect at least a reprehensive sample of this unique find. The quarry is relatively new and hopefully they will run into more collectable material soon. The potential is good for additional finds so we will keep an eye out when they shoot the wall in this area.



Article and photographs Submitted by Dave Callahan, Field Trip Chairman

Combined Lynchburg and Roanoke Clubs Rockydale Quarries Corp. Jacks Mountain Quarry December 16, 2006

This field trip materialized rather quickly as we had three possible choices. We had to wait for quarry conformation or rejection from one before we could contact the others. Our first choice will be rescheduled later this year. On December 16th, no one was available to be our host because the quarry was closed for the weekend.

Thanks to Royce and his Friendship with the Rockydale Quarry Owner, we were allowed access to the Jacks Mountain Quarry.

Even with such short notice, there were 7 from Roanoke and 6 from Lynchburg attending. The rock is very hard Amphibolite as we were told and it rapidly wears out the crushing and processing equipment.



Bill Livingston

Recap of 2006 Field Trips

January 21st----- VPI Geology Department.
February 21st----- Dale Quarry, Richmond
March 18th ----- Boxley. Mount Athos Quarry
April 7-9th----- First Annual Kentucky Geode Adventure
April 22nd -----Glendon, N.C.
May 20th ----- Staunton Lime Quarry
May 27th -----Morefield Mine
June 24th----- Faber Mine
July 22nd----- Rockfab Facilities. Roanoke
August 4-6th ----- Spruce Pine N.C. Weekend
August 19th -----Chestnut Ridge
September 16th ----- Boxley, Mount Athos Quarry
October 21st ----- Glendon. N.C.
November 18th ----- Mill Point, West Virginia
December 16th ----- Rockydale Quarries, Jacks Mountain Quarry



Up Coming Field Trips

For further information on field trips, contact David Callahan,
540-297-1853
Email dbc11@aol.com

**Combined Lynchburg/ Roanoke Club Field Trip
JANUARY 27, 2007 (9AM until NOON)
JAMES MADISON UNIVERSITY NEW GEOLOGY DEPARTMENT**

We will all provide our own transportation and meet in the JMU parking lot on the GRACE STREET side of the new facility, Memorial Hall (The old High School) promptly at 8:45 AM. If you need transportation or any other information, please call or e-mail Royce or me for assistance. This is Dr. Kearns only available date. If the weather is bad, use your own best judgment before driving. Dr. Kearns lives within walking distance so he will be there!

JMU has a fully equipped geology lab with state of the art equipment. Dr. Kearns is well known in his profession and has generously allowed us to visit his lab and dedicate this Saturday morning to our clubs.

If you have any minerals that you need to identify, bring them along. We should have time to run five or six specimens thru the x-ray diffraction equipment. There will be microscopes available and other equipment for testing and viewing. Dr. Kearns also has a large fluorescent mineral collection for our viewing pleasure. The Museum of Virginia and other minerals will not be open. A special room is being prepared but is not ready at this time.

DRIVING DIRECTIONS TO JMU HARRISONBURG, VA.

- * I-81 to Harrisonburg, VA. (About 2 to 2 1/2 hours driving time from Lynchburg).
- * Exit 245 (Turn left on Fort Republic Road)
- * Turn right on Rt. 11 South Main Street (Cross I-81 and it should be the third traffic light)
- * Turn left on W. Grace St. (this will be about the second traffic light)
- * Drive several blocks and you will see the Old High School on your right is MEMORIAL HALL. There is a little parking lot on the Grace Street side. We will gather here at 8:45 AM.
- * When you enter the building, go down one flight of stairs on your left. Enter the double doors and you are in the Geology Department. Walk around to your left, and the mineralogy lab will be open.
- * Bring any of those minerals you have that are unusual or need scientific identification. The lab is equipped with all the latest equipment and Dr. Kearns is very generous with his time in allowing us access to these facilities.
- * ***If there is sufficient interest and the weather is clear after we leave JMU, we will visit a new Quarry in the area so bring your hardhat, quarry gear and collecting equipment.***

Upcoming Field Trip Possibilities

February-----New Quarry !!!
March-----Bus trip to Smithsonian
April-----Second Annual Kentucky Geode Adventure
May-----Our DMC sponsored Field Trip



Rock Raiders

www.rocksforkids.com

During the winter months, when we are often forced to stay in doors perhaps stray from collecting, why not visit a new website or museum in of a quarry?

www.rocksforkids.com is a website sponsored by the Central Canada Federation of Mineralogical Societies in Bancroft, Ontario. I found the site very user friendly, and much information displayed in an appealing format.



The site has been recognized by the National science teachers association, and has a wealth of information for kids on rocks- from photographs of specimens, to identification, uses, safety tips, and related websites. They even have a link to the MSHA kids page.

"This site is for kids of all ages who love rocks. Here you will find out stuff about rocks & minerals and where to go to find out more. If you already collect rocks then this is the place for you! Find out where you can get more rocks, look at some super pictures of rocks, learn how to identify the rocks you already have and discover neat things you can do with rocks. Don't worry if you don't have a rock collection. There is something here for everyone. Come in and browse around & take a look at what Rockhounds do for a hobby. If you are doing a school project on rocks & minerals, you will find things here that you can use and you might even enjoy it!" *Re-printed from the home page of rocksforkids.com*

Mission Statement

Future Rockhounds of America is a nationwide nonprofit program within the American Federation of Mineralogical Societies that develops and delivers quality youth activities in the earth sciences and lapidary arts in a fun, family environment. Our underlying goals are to foster science literacy and arts education through structured activities that are engaging and challenging and by which kids- and the adults who mentor them- learn while having fun.

ITEMS FOR A GREAT DIG

D O L D C L O T H E S J K M O X S A F T Y G Z I S
 K S S L L S A F E T Y G L A S S E S I N B F J D R
 J T A R O C K P I C K F R E N M O S D E P I B K P
 Q O V S D I L T B N M X C A Y P J L M X I R T Y J
 W O T J H S T A H D R A H G V S C D O L I C S I S
 Z B Y R E M M A H E G D E L S A Z C I O L E R E N
 N E G B I S A N D W I C H B A G S I P O O S B W A
 O L L S T A H N Q B O I S R T M V T T E H N U O C
 P E A R E F C O J U H S A M M O P H S E R V C S K
 R E S W Q T J I V N R W F E E S B M K J T O K E S
 U T S M O E A B L E E C C T D R E G G L O V E S N
 A S E S O T V X T N L W Y S H R M O N U E T T S B
 P Q J S O Y T A B L X M C M R I E R E M M A H W E
 H N R E A S W E R E T A E W S N O R E W N K L B M
 P E T A Z Z I N V E X C H I T O O T H B R U S H W

SLEDGEHAMMER
 OLD CLOTHES
 STEELE BOOTS
 ROCK PICK
 SAFETY GLASSES
 SHOVEL
 TOOTHBRUSH
 WATER

SANDWICH BAGS
 CLOTH
 GLOVES
 HAMMER
 HARDHAT
 BUCKET
 SWEATER
 SNACKS



Your House Comes from a Mine

Originally developed by US Department of Interior, Bureau of Mines

Re-printed from www.rinkermaterials.com

Come inside and view your house, from a miner's point of view. Miners have seen a lot of it before, when they mined the raw materials used to build it.



The **foundation** and sidewalk are probably concrete (*limestone, clay, shale, gypsum and aggregate*) and the **driveway**—concrete or asphalt (*petroleum and aggregate*).



The exterior walls may be of **concrete block, brick (clay), stone or aluminum siding**, all provided by mining.



The **lumber in the walls, roof and floor** will be fastened together with nails and screws (*iron ore & zinc*).



The **roof** may be covered with asphalt shingles (*petroleum* and a variety of colored *silicates*), fiberglass (*silica sand*), clay, or corrugated *iron*.



The **gutters** can be made of galvanized steel (*iron and zinc*), aluminum (*bauxite*), or plastic (*petroleum*).

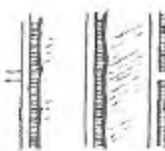

The **insulation** in the walls may be glass wool (*silica, feldspar, iron*) or expanded *vermiculite* (available from mining).



The interior walls are usually wallboard, made of *gypsum*.



If your house is painted, **paint** is manufactured with *mineral fillers* and *pigments*.

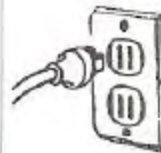

Your electrical wiring is of **copper or aluminum** (*bauxite*).



Your **plumbing fixtures** may be made of **brass** (*copper & zinc*) or **stainless steel** (*iron, nickel & chrome*).



Your **toilets, sinks and bathtubs** are made of **porcelain** (*clay*) over *iron*, or **plastic** (*petroleum*).

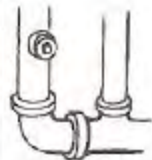

Your **sewer system** is made of *clay* or *iron* pipe (plastic pipes are made from *petroleum*); if you have a **septic tank** it is *concrete* and the leach field is filled with *sand and gravel*.



The **carpet** in your home is made from **synthetic fibers** (*petroleum*). The back is filled with *limestone*, even if your carpet is made of *wool*.



And finally, your **mortgage or rental contract** is written on paper made from *wood* or *cloth fibers*. The fibers are filled with *clay* and *other minerals* to determine its color and texture.



Your **windows** are made of **glass** (*iron, silica, sand and feldspar*).



Your **door knobs, locks and hinges** are **brass or steel** (*copper, zinc, iron ore, & alloys*).



Your **fireplace** may be made of *rock, brick*, or you may have a **wood/coal burning stove** (*steel, iron, alloys, etc.*). Your **furnace** is made of *steel* (*iron and alloys*).

SAFETY FIRST

by Bill Klose, EFMLS Safety Chair, EFMLS, re-printed from EFMLS news, January, 2007

Things I observed this year during the year I have had the privilege of attending a number of fine Federation and Commercial Gem and Mineral Shows and as a Museum Curator worked on many vintage collections. I want to share some of my observations.

At the shows I continue to see some tables that are overloaded with heavy specimens that could lead to collapse. One table contained a large flat of the mercury sulfide realgar specimens right up front where small children could reach them. A lady came up to a show chairman wanting to know if her Daughter should be taken to Emergency because she touched a piece of fused glass from a 1940 's atomic bomb blast. Small specimens, heavy specimens, and sharp specimens are commonly on the tables where they can be reached by small children. Shows in older facilities that do not have adequate outlets many times have strings of extension cords that exceed the National Electrical Code for the allowable number of outlets on a single circuit. Smaller facilities have a tendency to have very narrow aisles between rows of dealer's tables making the use of wheel chairs and electric carts very difficult for disabled visitors. Cardboard boxes and packing materials can easily become trip and fire hazards if not kept under control. Flat glass cases that are held open by single metal props could easily fall and pinch fingers. When holding or attending a show, look around for these potential problems and have them corrected for the safety of all in attendance.



The private and school collections that come in for processing are a source of wonder and disappointment. Many of the specimens are from old locations that no longer produce or have unique species not found anywhere else. Many of these specimens never had a label made for them because the collector or owner knew where they came from in their head or the label became lost or mixed up over the years and never had a catalog number on the label and specimen. A school teaching collection with many specimens over 100 years old had over 70 percent of it 's labels missing or misplaced. The 30 percent with labels were a fine addition to a research collection and the remainders were donated to teachers for general education, so all was not lost. One collection of pyrite-replaced fossils that were not properly stored took on moisture from the air and altered to sulfuric acid resulting in drawers of white powder. Some hazardous minerals and chemicals are also found in collections without labels or warnings. The most important information that should accompany a specimen is location. Names of the species of minerals or fossils can change over the years as more is learned about them.

This year collections were curated that contained lost "type " or original specimens of species and species from classic locations that have never been recorded in the literature. Many collections were put together when large or very fine examples were available, and even before the specimens contained were given names by scientists. Many species were originally described by scientists in private collections or once described, just put out in the general collection and over time have become lost to science. Many of James Hall 's (early New York State Paleontologist)described fossils were just put out in the next collection leaving the New York State Museum and have never been recovered from or recognized in these collections.

Bearing in mind that our children are rarely interested in the things that we are, we can protect our collections by labeling and numbering the specimens and providing notation about those that are rare or hazardous on the labels. This will maintain the value of the collection and help with the eventual dispersal of the collection. So many fine collections and hazardous specimens are just thrown out. There is a saying that "amateurs have the best specimens ". Many put together their collections over many years and are there when the more unusual species or finer specimens appear, where scientists many times only are able to collect during one or two trips to a site or when funding is available.

Schedule of Events

February 7th, 7:00 pm- Executive Board Meeting. Contact any board member for more details.

February 24th- 25th- James Campbell Memorial Gem, Mineral, and Fossil show and sale, New York State Museum, Empire State Plaza, Albany, NY

March 3rd & 4th- Show and Sale, Delaware Mineralogical Society, Delaware Technical and Community College, Newark, DE

March 9th-11th-Aiken-Augusta Gem, Mineral and Fossil show and sale, Julian Smith Casino, 2200 Broad St, Augusta, GA

March 16th-18th- Catawba Valley Gem and Mineral club show & sale, Hickory Metro Convention Center, Hickory, NC

April 20th-22nd- Treasures of the Earth Gem Show, Charlottesville, VA. details at www.toteshows.com

January 2007

Sun	Mon	Tue	Wed	Thu	Fri	Sat
	1	2	3	4	5	6
7	8	9	10	11	12	13
14	15	16	17 Meeting 7PM	18	19	20
21	22	23 Woolleys Workshop 7PM	24	25	26	27 JMU Field Trip
28	29	30	31			



Workshops (members only) at Dave Woolley's home on the fourth Wednesday of each month. 7-9PM.

Cutting, polishing, jewelry making and microscopy are just some of the monthly features. Please join us!

PROGRAMS for 2007

To be chiseled in granite and gold plated as the granite and gold become available.

January - Virgin Valley Opals by Ed Blackwell

February - Morefield Mine and Alaska - Sam and Sharon Dunaway

March - Morenci Copper Mine and Fire Agate - Bill Gilbert EFMLS

April - Fluorescent Minerals and Franklin Mine

May - Mineral Identification Night

June - Student Night by Rock Raiders

July - Video

August - Crystallography Three by Steve Boylan

September - Open Invitation

October - Collectors Night

November - Auction

December - Christmas Annual Awards Meeting



Important Web Sites: Lynchburg Gem and Mineral Society: www.lynchburgrockclub.org

American and Southeast Federation Websites:

The SFMS Newsletter, the Eastern Federation Newsletter, and the AFMS Newsletter are available for all members to read on line at: www.amfed.org/sfms, www.amfed.org and www.amfed.org/efmls

Geology Concepts

Part V of a monthly feature by Club Member Dave Woolley, Geologist
Geologists identify earth materials by mineral content, origin, and particle size.

Part VI~

Igneous texture is the fabric of the interlocking mineral grains crystallized in igneous rock. Igneous rock typically has no preferred directions of strength or of weathering.

Note: Chemical weathering accelerates by the increased surface area at the *corners* of joints sets in igneous rock, especially diabase, leaving fresh "core stones" in residual soil that may eventually accumulate on the surface as rounded boulders and cobbles as the soil is eroded.

Igneous texture often causes "spheroidal weathering".

Strike and Dip are geologic terms used to describe the orientation of planar features in rock such a joint or schistosity. Strike is the compass direction of the line formed at the intersection of an inclined plane at the earth's surface, such as N37W (North 37 degrees West). Note that adding or subtracting 180 degrees describes the same line: Strike in the Northern Hemisphere is referenced from the North. "Strike and Dip" have been replaced with "Dip Direction and Dip Value".

The new system consists only of numbers:

Dip Direction (DD) is the azimuth bearing (0 east through 360 degrees) describing the compass direction a marble will roll down a tilting plane.

Dip Value (DV) is the number of the angle (0 through 90 degrees) formed by an inclined plane and an imaginary horizontal plane at the Earth's surface. A horizontal DV would be 0 degrees; vertical is 90 degrees.

Outcrop (Noun) The location of an exposure such as; "There is an outcrop of bedrock in the pasture."

Outcrop (Verb) As in "Bedrock outcrops in the pasture."

Daylight (*slang*) "exposed to the light of day". A discontinuity in soil or rock may be visible or "daylight" in a cut slope creating a potential for slope failure.



This concludes the original (July, 2006) version of Geology Concepts by Dave Woolley, Geologist. There will be excerpts from the revisions of this writing periodically in the coming issues of the Gem and Mineral Journal, courtesy of Dave Woolley.

From the First VP: *cont. from pg. 1*

These are the Eastern Federation of Mineralogical & Lapidary Societies, the Dixie Mineral Council, the Southeast Federation of Mineralogical Societies and the American Federation of Mineralogical Societies. These organizations present a great opportunity for us to share our interests with others across the country.

For January's meeting we have invited guest Ed Blackwell to present a program about opals from Virgin Valley, Nevada. These are beautiful precious opals formed as a replacement for wood. Let's give Ed a warm welcome to Lynchburg.

And one more time, bring back the ugly rock contest. Hurry, hurry, hurry! Get your ugly rock in the ugly rock contest. Entries are only \$1.00. Votes are free. And the winner will split the pot with the club.

sayonara
Steve!

Results of The Member Survey for 2006

by Steve Boylan

Thank you to all who participated in the 2006 member survey. A special note goes to Tuel Jewelers in Charlottesville for sending in the first response. The following are the results of the survey.

Our favorite colors are yellow, green, red and blue. And our favorite minerals are topaz, calcite, garnet and emerald. The minerals in greenstone are chlorite, epidote, actinolite and feldspar. Kyanite, quartz, hematite and mica along with willisite have been identified as having been found at Willis Mountain.

We most enjoyed the field trips to Boxley Mt Athos, Farber mine, Glendon, Boxley Blue Ridge and Beckley WV and all where rocks and minerals were collected. Some new locations for field trips are Lone Jack Quarry, Glasgow and Old Buck Mt Mine Rt. 60 W Amherst. The programs enjoyed most were gold panning, mineral identification, crystal forms, geology instruction and flint knapping.

Suggested new topics for programs are faceting 101, geology around Lynchburg, gem cutting and fossils. Also suggested for future activities are a library display, educational videos and fossil programs. The newsletter received excellent comments.

Participation in the Rock Raiders is still low. And we like the news, pictures and field trip information on the website.

Our overall satisfaction rating for 2006 is 9.4 with a range of 8 to 10 on a scale of 1 to 10. The respondents to the survey are in the age range 41+.

Our preferences are for kyanite, Lynchburg, emails, barbecue, field trips, and salt. We have split preferences about rocks or minerals; brilliant cut or cabochon; igneous or metamorphic; Farber lead mine or RockFab; wire wrapping or gem trees; triclinic or trigonal; and fluorescent rock or fossils. And one independent respondent followed the instruction literally by circling all the 1's.

Our interests are in the areas of geology, cabochons, lapidary, writing, wire wrapping, advertising and sales.

Minute's ... cont. from pg.2

not only for the awards she won, but also for the time and energy it takes to prepare just one entry! Please CONGRATULATE NATALIE and thank her for her expertise in bringing recognition to Lynchburg.

All who received awards deserve a round of thanks!

The election of officers was held and the election committee presented the slate as follows:

President – John Haskins

1st V.P. – Steve Boylan

2nd VP – Dave Callahan

Secretary – Dee Tinsley

Treas.-Franklin Midkiff

Editor: - Natalie Darling

Members at Lodge:

Joann Mason

and Ralph Torning.

All officers were re-elected as presented. There were no nominations from the floor.

The meeting was adjourned and the festivities began. We played "Dirty Santa" and everyone had fun participating or watching! The food was excellent and we all enjoyed a "feast".

Thanks to all who prepared the food, it was delicious!

Respectfully Submitted:

Dee Tinsley, Secretary

Happy New Year!



Gem & Mineral Society of Lynchburg, VA Inc Membership Application

(All information for official club use only)

Date _____

Print Name _____

Address _____

Phone _____

Email _____

Additional Members Names:

Spouse/ Sig. _____

Other _____

Children/

Ages _____

**Dues: First Person: \$15.00 per year,
Each additional family member \$3.25**

Mail To:

P.O. Box 2348

Lynchburg, VA 24501

The Gem & Mineral Society of Lynchburg, VA Inc.

Natalie Darling, Editor

211 Chesterfield Rd.

Lynchburg, VA 24502 www.lynchburgrockclub.org

The purpose of the Gem & Mineral Society of Lynchburg, INC. is to promote education in The Earth Sciences including: Mineralogy, Geology, Gemology, Paleontology, and Crystallography



Lynchburg Rock Raiders is the official FRA association of The Gem & Mineral Society of Lynchburg, VA INC

